

sceb-1,2,5

the pacesetter in quality prefab roof products



245 eisenhower lane south • lombard, illinois 60148
 630.705.1920 • 800.243.3018 • fax 630.705.1930
 www.patecurbs.com • e-mail: sales@patecurbs.com

pate solid cover equipment base

standard construction

Heavy ga. galvanized steel, unitized construction, with full mitered corners and all seams welded, 1 1/2" thick rigid fiberglass insulation in curb. Pressure treated wood nailer, 3/4" exterior grade plywood deck and galvalume counterflashing. Larger sizes will have supplemental bracing under plywood deck.
 Also available in **sceb-1** and **sceb-5** styles.

p.o. no. _____
 customer _____

 project _____
 location _____

 architect _____
 engineer _____

pate equipment base

sceb-2

sceb-2 shown

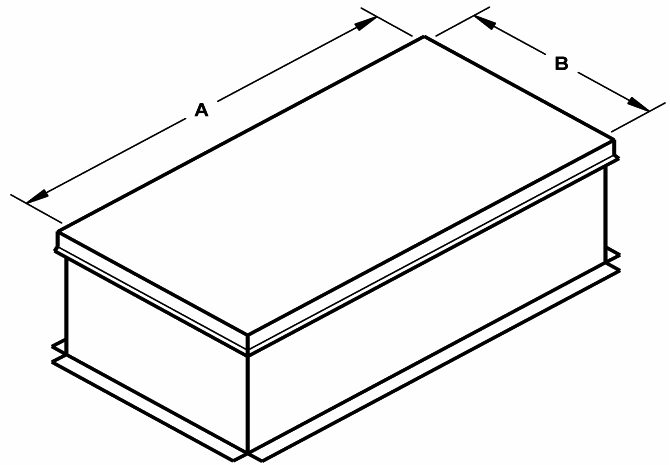
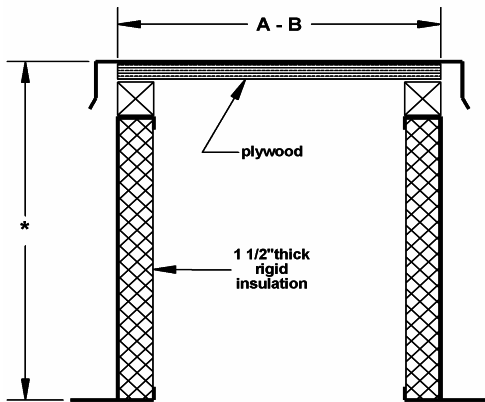

equipment base requirements

quantity	style	dimensions		* overall height	wall thickness	raised cant ht. 5 style	plywood thickness	tag
		O.D. A x B	I.D.					