

pts

the pacesetter in quality prefab roof products



245 eisenhower lane south • lombard, illinois 60148
 630.705.1920 • 800.243.3018 • fax 630.705.1930
 www.patecurbs.com • e-mail: sales@patecurbs.com

pate thermal skylights

standard construction

All thermal models shall be double dome. Domes shall be thermoformed from one-piece acrylic plastic. Outer dome shall be clear colorless, bronze, or gray. Inner dome shall be clear colorless or translucent white. Skylight frame and retaining angle shall be extruded aluminum, with a thermal barrier to reduce convection. Each skylight shall be supplied complete, ready for attachment to a 1 1/2" wide curb. **Pate** curbs for proper installation are available separately.

p.o. no. _____
 customer _____

 project _____
 location _____

 architect _____
 engineer _____

pate thermal skylights

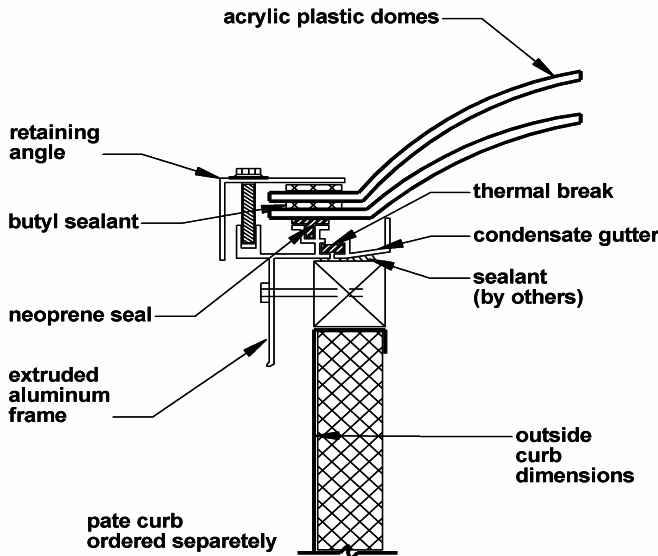

Thermal models exceed the requirement of BOCA and SBCCI for exemption from "u" value consideration.

standard sizes	
model no.	inside curb dimension
square	
pts-2424	19 x 19
pts-2828	22 1/4 x 22 1/4
pts-3636	30 1/4 x 30 1/4
pts-4242	37 x 37
pts-5252	46 1/4 x 46 1/4
pts-6060	55 x 55
pts-7676	69 1/2 x 69 1/2
pts-8080	75 x 75
pts-9898	92 1/2 x 92 1/2
rectangular	
pts-2052	14 1/4 x 46 1/4
pts-2852	22 1/4 x 46 1/4
pts-3296	25 1/2 x 89 1/2
pts-3652	30 1/4 x 46 1/4
pts-3676	30 1/4 x 69 1/2
pts-4280	37 x 75
pts-4365	38 x 59
pts-5276	46 1/4 x 69 1/2
pts-5296	46 1/4 x 89 1/2
pts-6476	57 1/2 x 69 1/2
pts-6496	57 1/2 x 89 1/2

other sizes available upon request

thermal skylight requirements

quantity	*style	dimensions	glazing		tag
			inner dome	outer dome	